



Kabuto

Japan

AVANT II



Instruction Manual

! BEFORE USE

**PRIOR TO USE, READ THIS INSTRUCTION
MANUAL THOROUGHLY AND KEEP THIS
FOR FUTURE REFERENCE**

AVAND II

AVAND-II Instruction Manual Table of Contents

AVAND-II Instruction Manual Table of Contents.....P-2

Helmet Description.....P-3

FOR SAFE AND COMFORTABLE USE

NOTES BEFORE USE.....P-4

CHINSTRAPS

1 Remove/Replace Chinstrap Covers.....P-6

2 Fastening Chinstraps.....P-7

AIR-CONDITIONING FUNCTION OF VENTILATIONS

3 "Ventilation System" and "Wake Stabilizer".....P-8

4 Open/Close Head Ventilations and Rear Ventilations.....P-9

SHIELD

5 Single Action Shield System.....P-10

6 Remove/Replace Shield Ratchets.....P-12

Optional Parts  **PINLOCK®** Original Insert LensP-14

INTERIOR (INNER PAD AND CHEEK PADS)

7 Remove/Replace Cheek Pads

NOTE

Exchangeable Inner Pad, Cheek Pads and Chinstrap covers.....P-18

8 Remove/Replace Inner Pad.....P-18

IMPORTANT

Cleaning of Inner Pad, Cheek Pads and Chinstrap Covers.....P-19

PARTS LIST

• AVAND-II Series Parts List and Table for Replacement.....P-20

Contact for inquiries and request for repair.....P-21

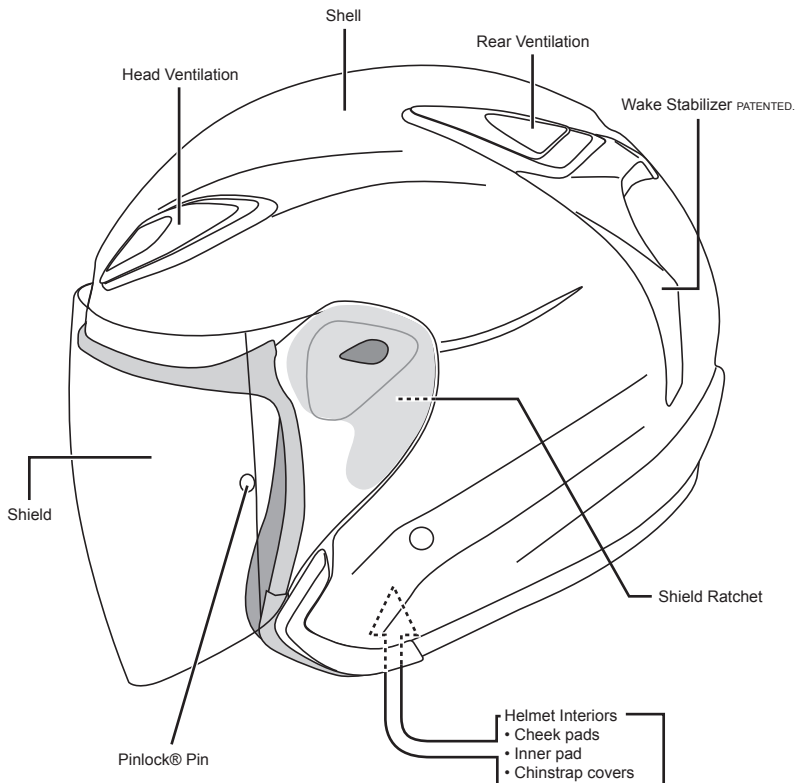
**COOLMAX®**

COOLMAX® is used for the interior fabrics in order to allow quick evaporation of sweat and brings cool and comfortable use.

–Evaporate sweat quickly to achieve cool and comfortable use–

- When sweat comes out from the body, COOLMAX® allows discharging body moisture to the outside and takes in air from the outside to cool and dry your body. As a result, the temperature on the body surface is lowered and exercise great moist adjustment accordingly.
- COOLMAX® provides a natural touch to the texture with soft and light weight and good permeability properties.

*COOLMAX® is the registered trade name of INVISTA.

NOTES BEFORE USE

Thank you very much for purchasing a KABUTO helmet.

This Instruction Manual describes proper handling, various functions and remove/replace each part of this helmet. Please read this Instruction Manual thoroughly prior to use.

After reading this, keep this Manual for future reference.

The helmet is just one element of protection, it is intended to minimize the risk in the event of an accident. It cannot ensure complete safety.

Use this helmet properly based on this understanding.

Please understand and follow the instructions and information in this Instruction Manual to enjoy your safe ride.



Select the proper size!

It is very dangerous to wear a too large sized helmet. This may wobble while riding. If you wear a too small size helmet, it tightens up and hurts your head. Thus, it is important to select the proper size.



Fasten the chinstraps before riding

The helmet is designed to be retained by straps under the chin. In order to assure proper protection, the helmet should fit your head. When worn, adjust it to rest properly on the head, securely fasten the chinstraps to ensure safety. The chinstraps prevent the helmet from coming off in most cases.



Never use the helmet once impacted

Liners are essential for the intended performance of the helmet.

This helmet has been designed to absorb the impact energy when components as shell and liners are partially destroyed by an impact.

Even if visually no damage is apparent, it could be seriously damaged by a small impact.

Regardless of the degree of damage, the helmet that underwent an impact or was abused even only once should not be used anymore.

Always handle the helmet with care and make sure that no one sits on it or drops it.



Never modify the helmet

In order to fully maintain the performance of this helmet, do not attempt to take apart or change the helmet in any manner such as making holes in it or cutting it.



Helmet care and cleaning

Clean the helmet with soft cloth, using common ph-neutral detergent diluted with clear water. The cloth should not be soaking wet. Then wipe the helmet gently with a clean wet soft cloth and leave it to dry completely, but not in direct sunlight.

With regard to helmets with removable interiors, carefully read the instruction manual for that model before attempting to remove the interiors and carry out cleaning according to the explanation provided. To clean the helmet do not use saline water or hot water (above 50°C).



Do not paint or apply solvent

Any paint, glue, adhesive stickers, etc. (or the use of detergents and solvents other than those prescribed) may not only reduce the original protective performance of the helmet considerably, but may also cause damage to the helmet that cannot be detected by the naked eye.



Handle your helmet with care

Do not toss your helmet over a floor or sit on it. The helmet absorbs an impact every time it is handled roughly and its impact-absorbing capacity will be decreased. Handle your helmet with care to assure its full intended function in the event of an accident.

Do not use your helmet for any purpose other than to use for protecting your head while riding.



The storage of the helmet

After using the helmet, stow it away in the helmet bag and store on a level place such as a shelf; the helmet may be damaged if it rolls around or falls down.

Do not leave the helmet in direct heat above 50°C e.g. next to a heater or under direct sunlight in a car.



Shield care and cleaning

After using your helmet, with a wet soft cloth, lightly wipe off any grime (e.g. dead insects, dirt, sand, dust, etc.) on the shield and then fully wipe it clean using a dry soft cloth. When the shield gets wet (e.g. rainwater), it should always be wiped with a soft cloth after use.

When cleaning the shield, never use any petroleum-based solvents or detergents containing abrasives.

Contact with petroleum products and other solvents may impair the optical properties and reduce the mechanical strength.

To clean the shield, apply some common ph-neutral detergent diluted with clear water using a soft cloth and wipe gently. Finally, wipe it dry with a lint-free soft cloth. To clean the shield, do not use saline water or hot water (above 50°C).



Cautions for shield

If the visor is marked "Day Time Use Only", visibility is limited to daylight conditions and it is not suitable for use at night.

Tinted lenses are not suitable for use at night.

A visor and goggles with scratches lowers the visibility and this is very dangerous. Such visors should never be used at night and should be replaced.

Contact with petroleum products and other solvents may impair the optical properties and weaken the strength of the visor.

Never try to open or close nor remove the visor while riding.



Notes for use of full-face helmet

When you wear a full-face helmet, the temperature in the helmet is maintained nearly constant while riding but the surroundings are constantly changing since you are moving at a high speed. For this reason, in case of sudden rain, entering a tunnel or in a place with a large height difference, the shield can be fogged suddenly because of the difference in temperature in-and outside the helmet.

In case such a risk is expected, please use caution with adjusting the shield or slowing down your speed in advance.

Never open or close the shield nor adjust the ventilation shutter while riding since it is very dangerous. Adjust the shield before riding.

1 Remove/Replace Chinstrap covers

When the chinstrap covers of AVAND-II helmet become dirty, they may be washed after detaching them from the chinstraps.

–DETACHING–

- ① Undo the hook and loop fastener at the end of each chinstrap.
- ② Pull the chinstrap cover from the chinstrap to detach it.

–ATTACHING–

- ① In the reverse order of detaching (Pay attention to the direction of the chinstrap cover), let the chinstrap go through from the upper portion of the chinstrap cover.
- ② Finally, fasten the snap.

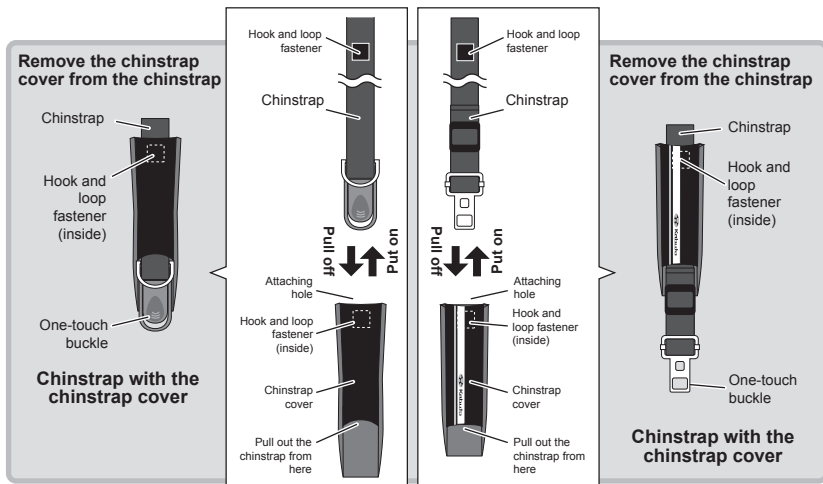

! CAUTION!

Please pay attention to the side of the chinstrap covers.
The side where your chin touches is the back.

Fully-washable interiors

The inner pad, the cheek pads and the chinstrap covers of this helmet are all washable. Please wash them by hand or washing machine (must use a washing net) with mild soap or diluted detergent. Dry them in the ventilated area after washing. Please refer to page 19 for more details.

"ECE22-05 approval label"

• This label shows that the product conforms to the test standard ECE22-05, and is issued one sheet per one product with a serial number authorized by the inspection organization thereof. In sales in European areas, it is obliged to display this label by sewing it directly on a chinstrap.

Fastening Chinstraps

Fixation des mentonnières / Kinnriemen festziehen / Allacciare il sottogola

Ajuste de las correas de la barbilla / De kinriemen vastmaken / Fästa hakremmar

Zapinanie pasków podbródkowych / Stram Hageremmene

Δέσιμο λουριών πιγουνιού / Apertar as correias para o queixo

Leukahihnojen kiinnittäminen / あごひもの取扱方法

Unfastening

Détachement

Öffnen

Per slacciare

Desatar

Losmaken

Lösgöring

Rozpinanie

Løsne

Λύσιμο

Desapertar

Irrottaminen

脱着時

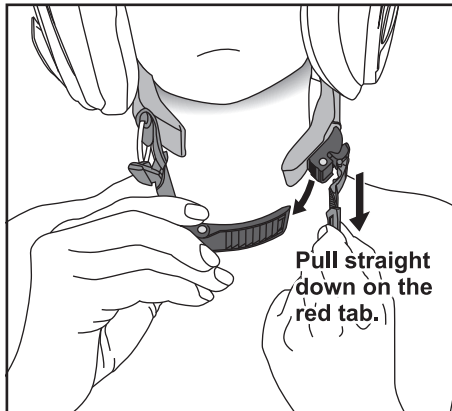

Fastening

Fixation

Schließen

Per allacciare

Fijación

Vastmaken

Fästning

Zapinanie

Fastspænding

Δέσιμο

Apertar

Kiinnittäminen

装着時

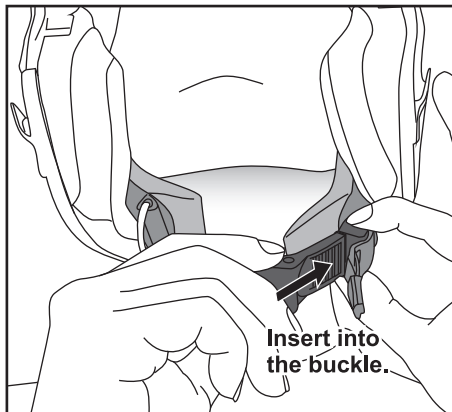

OGK KABUTO

Kabuto Global Site: www.ogkkabuto.com

2 Fastening Chinstraps

One-touch buckle

One-touch buckle makes it easy to take on and off your helmet.



WARNING!

Be sure to fasten the One-touch buckle securely before riding. If the One-touch buckle is not fastened or not fastened securely, your helmet may drop off in case of an accident or when falling down while riding and may cause serious injuries.

Fastening

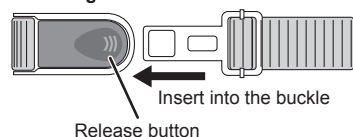

Unfastening

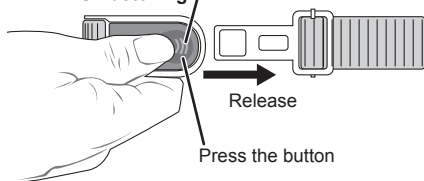

Adjusting the chinstraps length

Proper chinstraps length

Fasten the One-touch buckle securely when wearing the helmet. The proper chinstrap length would allow your forefinger to slip in between the chinstraps and your neck. If the length is not proper, please adjust the length of the chinstraps.

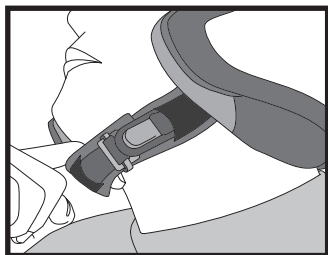

<Side view>

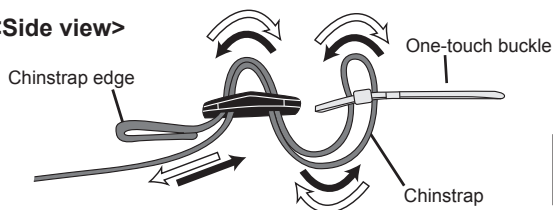

➡ Shortening
➡ Lengthening



WARNING!

Be sure to adjust the length of the chinstraps of the helmet properly. Otherwise, your helmet may drop off or choke your neck in case of an accident while riding. Chinstraps play a very important role. Thus, please adjust the chinstraps of your helmet properly and securely before riding.

3 “Ventilation System” and “Wake Stabilizer^{PATENTED}.”

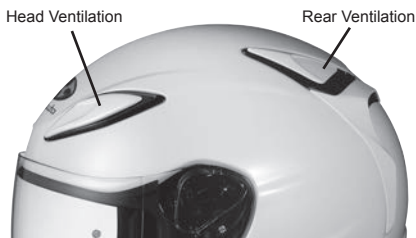

Ventilation System:

The ventilation system effectively takes outer air in and pushes the inner humid air out by the air pressure from the front while riding. The ventilations are equipped with a shutter which prevents cold air and water drops from coming into the helmet.

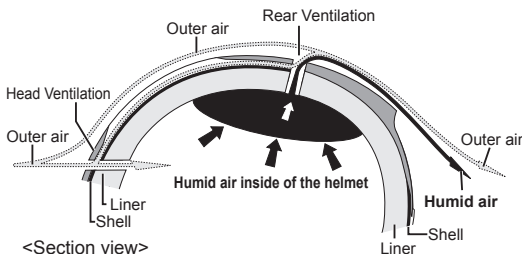

Wake Stabilizer^{PATENTED} :

The Wake Stabilizer^{PATENTED}, KABUTO's unique system, is developed by analyzing the results of wind tunnel experiments at several angles. This unique system controls the airflow around the helmet and reduces loads while riding.

! CAUTION!

The Wake Stabilizer^{PATENTED} is sophisticatedly designed to achieve light-weight and minimize damage on your head in case of an accident. The Wake Stabilizer^{PATENTED} may be damaged by a strong impact. Handle them with care.

4 Open/Close Head Ventilations and Rear Ventilations

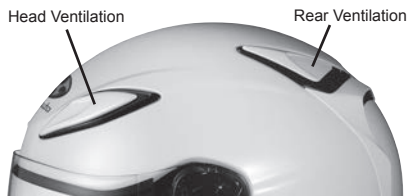

Open/Close Head Ventilation:

To Open

Slide the shutter backwards to introduce air from the outside.

To Close

Slide the shutter forwards to shut off air from the outside.

To Open

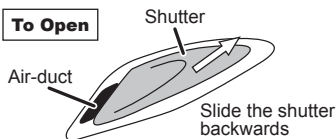

To Close

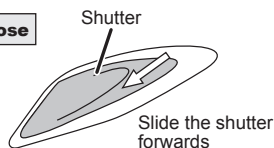

Open/Close Rear Ventilation:

To Open

Slide the shutter backwards to discharge the inside humid air.

To Close

Slide the shutter forwards to stop forcing out the inside humid air.

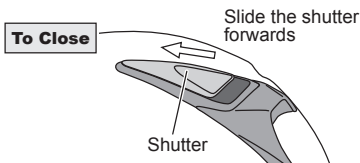
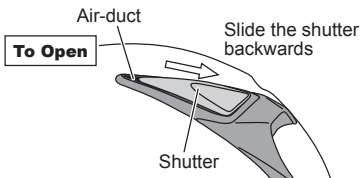

⚠ CAUTION!

Do not put strong pressure on the ventilations.
Make sure to treat them with care.

Please read "WARNING" and "Repairing the ventilations" on the next page.

⚠ WARNING

- Operating the shutter while riding is very dangerous. Never operate the shutter while riding. Operate it before riding.
- The air-ducts (air intakes and discharge holes) of the head ventilations and the rear ventilations are designed in the proper sizes and quantities considered a large impact in the event of accidents and falling down. Customizing by enlarging or making more air-ducts would reduce the safety performances significantly and can cause serious injuries in case of an accident. Never customize your helmet.

! Repairing the ventilations

When each ventilation is damaged, contact your local authorized Kabuto dealer. (See Pages 20 to 21).

Please be informed that we may not accept repairing, in the case the safety performance of the helmet will be degraded.

5 Single Action Shield System PATENTED.

The “Single Action Shield System PATENTED” is the shield replacement system developed by KABUTO. The system allows quick shield replacement for riding and racing conditions and easy maintenance.

How to remove the shield:

- ① Move the shield up (Fig. 1). (Move it up as far as it goes.)
 - ② As shown in Fig. 2, pull the shield in the direction of the arrow while pressing down the release button on the shield. One side of the shield is completely removed.
- *The shield can be removed easily by pulling it along the angle of the end of release button.
- ③ Repeat the same procedure for removing the other side of the shield. Then the entire shield can be completely removed.

! CAUTION

- The shield is so constructed that it cannot be removed unless it is moved up to the highest position.
- Do not pull or twist the shield by force to remove it. Such action may damage the shield and ratchet system.
- Handle the removed shield with care in order not to damage it.

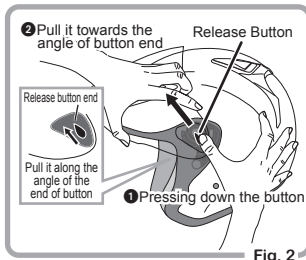
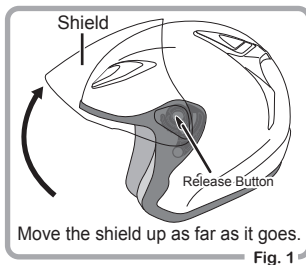

How to attach the shield:

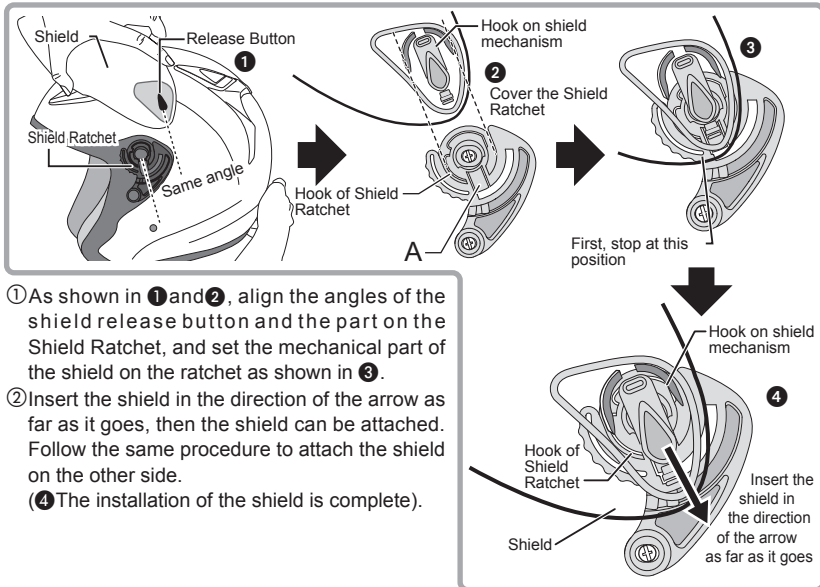

- ① As shown in ① and ②, align the angles of the shield release button and the part on the Shield Ratchet, and set the mechanical part of the shield on the ratchet as shown in ③.
- ② Insert the shield in the direction of the arrow as far as it goes, then the shield can be attached. Follow the same procedure to attach the shield on the other side.
- ④ The installation of the shield is complete).

CAUTION

- Do not push or twist the shield by force when installing it. Such action may damage the shield and ratchet system.
- After the installation of the shield, be sure to pull it lightly towards the removing direction to make sure that it is securely installed.
- After the installation of the shield is completed, open and close the shield three to four times to make sure that the shield works properly.

WARNING

- After the installation of the shield, make sure the shield is securely installed and that it is properly opened and closed before riding. If the shield does not work properly, or is installed insecurely, it may cause a failure in opening and closing the shield or lead to the removal of the shield while riding, thereby causing a great risk. If the opening and closing operations are not properly performed or abnormal noise is heard during these operations, check the steps in the installation procedure and repeat the installation procedure from the start.
- The shield is a consumable item. If the shield surface is damaged by a bug, stone, etc., it may hinder the vision, thereby causing a great risk. If the shield gets extremely dirty or scratched, replace it with a new one.

6 Remove/Replace Shield Ratchets

The "Shield Ratchet" is a part to control the open/close the shield and the function of the "Single Action Shield System^{PATENTED}."

When the shield is completely removed in the procedure mentioned in 5"Single Action Shield System^{PATENTED}.", the Shield Ratchet appears.

How to remove the Shield Ratchet:

Turn the Shield Ratchet Screws on the Shield Ratchet counterclockwise using a proper sized flat-blade screwdriver until the screws are removed. Then, the shield ratchet can be removed. Follow the same procedure to remove the Shield Ratchet on the other side.

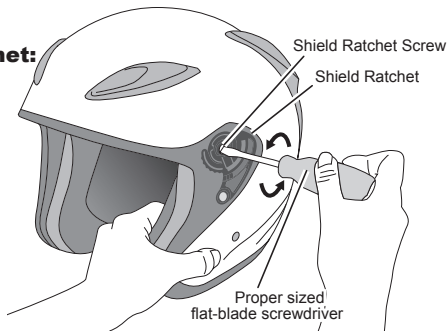

CAUTION

- Use the proper sized screwdriver to remove the Shield Ratchet Screws. Turn the screw by applying the screwdriver vertically to the screw. If the improper sized screwdriver is used or the screw is turned diagonally, the threads may be stripped.
- Do not lose the removed screws.
- The Shield Ratchet Screws are the lock coating screws. Do not keep using the screws when the coating is peeled off and replace a new one

How to install the Shield Ratchet:

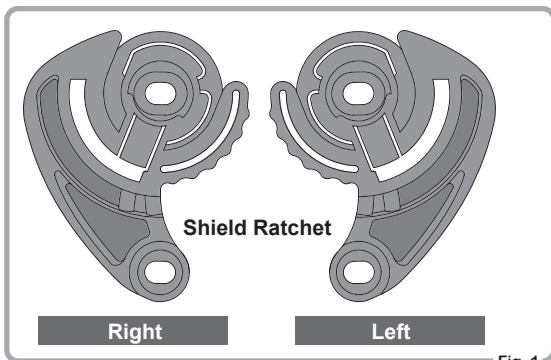

- ① First, check the side of the Shield Ratchet as shown in Fig. 1.

Fig. 1

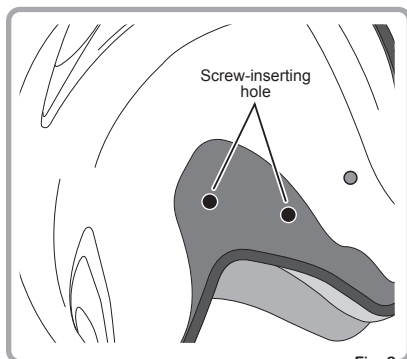

Fig. 2

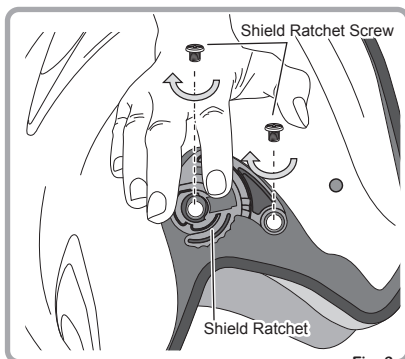

Fig. 3

- ② Place the Shield Ratchet in the hollow space on the side of the helmet and align the mounting holes on the shield ratchet with the mounting holes on the helmet (Fig. 2).
- ③ Fasten the both Shield Ratchet Screws clockwise securely. Repeat the same procedure on the other Shield Ratchet. Then the Shield Ratchets are installed (Fig. 3).

⚠ CAUTION

- Do not fasten the Shield Ratchet Screws too tight. Too much tightening of the screws may damage screws and other parts.
- Fasten the Shield Ratchet Screws by applying the screwdriver vertically to the screws. If the screws are fastened by applying a screwdriver diagonally, the threads may be stripped.

⚠ WARNING

- The Shield Ratchet is an important part for open/close the shield. Install the Shield Ratchet securely. After the installation is completed, check to see that the shield can be closed to the lowest position and opened and closed correctly.
- Check and fasten the Shield Ratchet Screws regularly. Riding with the loosened Shield Ratchet Screws is very dangerous as the shield may be removed while riding.
- The Shield Ratchet Screws are the lock coating screws. Do not keep using the screws when the coating is peeled off and replace a new one.

Optional Parts

PINLOCK®

Original Insert Lens

PINLOCK® Original Insert Lens is the effective anti-fog sheet.
The visor of your helmet has PINLOCK® pins (eccentric pins).
The PINLOCK® Original Inset Lens can be purchased at the authorized Kabuto dealer.

Pinlock®Original Insert Lens	For SAJ-P	1 sheet
-------------------------------------	-----------	---------

Pinlock®Original Insert Lens:

Pinlock® Original Insert Lens prevents the shield from fogging caused by thermal changes in winter or rainy weather etc.

Maintaining the proper space between the shield and the Pinlock® Original Insert Lens provides clear vision by balancing the inner and outer temperature.

Pinlock® has international patent protection and is a registered brand name of Pinlock systems B.V. Further patents have been applied for.

How to Fit the Pinlock® Original Insert Lens:

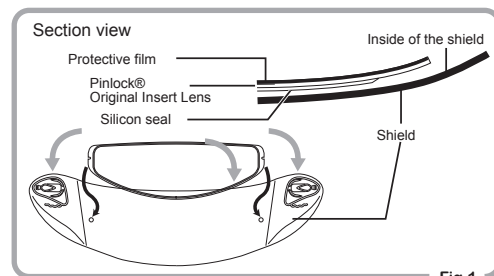

Fig.1

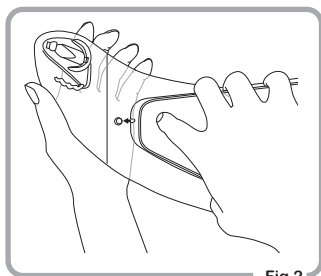

Fig.2

- ① Apply the silicon seal side of the Pinlock® Original Insert Lens on the inside of the shield, without peeling off the protective film on the lens. At the time, apply the Pinlock® Original Insert Lens on the inside of the shield by clicking it into the eccentric pins. (Fig 1 and 2)

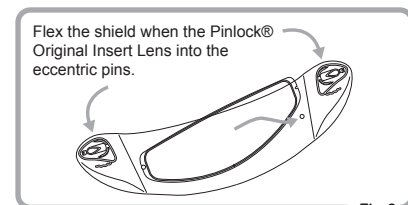

Fig.3

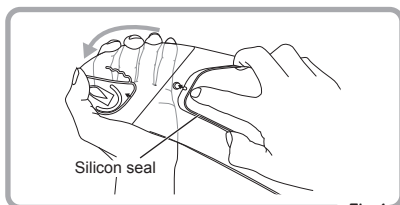

Fig.4

- ② Flex the shield carefully until the shield becomes flat. Then, click the other side of the Pinlock® Original Insert Lens into the eccentric pins and then allow the shield to return carefully to its original curved shape. (Fig. 3 and 4) (Follow 3)

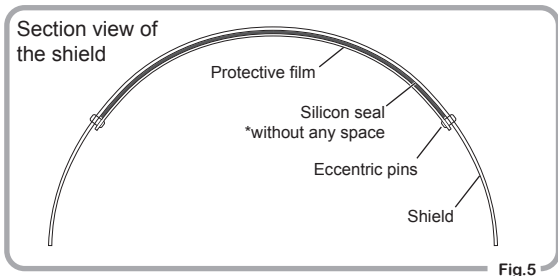

Fig.5

- ③ Make sure if the overall silicon seal of the Pinlock® Original Insert Lens is attached firmly to the shield by mounting the shield on the helmet. If there is any space between them, refer to “How to Adjust Pinlock® Original

Insert Lens after Attachment” and adjust the lens.

*Please mount the shield on the helmet when checking if the Pinlock® Original Insert Lens is attached firmly to the shield. Otherwise, the shield might be spread out by the pressure from the lens and it cannot be assured if the lens has attached on the shield firmly.

- ④ Peel off the protective film on the Pinlock® Original Insert Lens.

–How to Remove Pinlock® Original Insert Lens–

- ① Remove the shield from the helmet.
- ② Remove the Pinlock® Original Insert Lens from the eccentric pins by flexing the shield. (Fig.6)

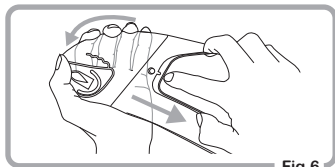

Fig.6

How to Adjust Pinlock® Original Insert Lens after Attachment:

Adjust the Pinlock® Original Insert Lens if there is any space between the lens and the shield.

- ① Remove the shield from the helmet and detach the Pinlock® Original Insert lens from the shield.
- ② Adjust the eccentric pins by turning them with a tool. (Fig. 7)
- ③ Fit the Pinlock® Original Insert Lens back on the shield. Make sure the Pinlock® Original Insert Lens and the shield do not have any space in-between after attaching the shield on the helmet. If there is any space please follow the same steps again.

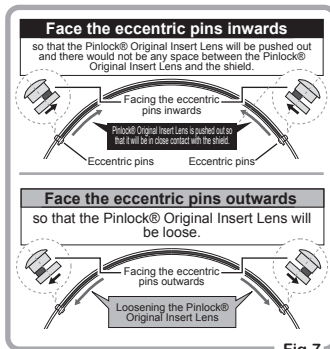

Fig.7

* Please read carefully the “**CAUTION**” and the “**CAUTION *Pinlock® Original Insert Lens**” on the next page.

! CAUTION

- Flex the shield properly when fitting the Pinlock® Original Insert Lens. Otherwise, eccentric pins may be damaged.
- Clean the inside of the shield before applying the Pinlock® Original Insert Lens. Pay attention not to touch the anti-fogging part of the silicon seal side on the Pinlock® Original Insert Lens.
- Do not use any petroleum products, thinner, glass cleaner, etc. It will degrade the material of the Pinlock® Original Insert Lens.
- Do not leave the Pinlock® Original Insert Lens where the temperature may surpass 50°C or near a heater, neither use a drier nor fire for drying. Heat may degrade the material of the Pinlock® Original Insert Lens.

! CAUTION *Pinlock® Original Insert Lens

- Pinlock® Original Insert Lens is only for exclusive visors.
- If rain or water drops come in the space between the Pinlock® Original Insert Lens and the shield, please detach the Pinlock® Original Insert Lens from the shield and dry them out. Then, reattach the Pinlock® Original Insert Lens on the shield.
- Please remove the Pinlock® Original Insert Lens at times for maintenance. Otherwise the silicon seal of the lens would adhere to the shield.
- Do not use any shields or pins other than exclusive ones for the Pinlock® Original Insert Lens.
- Please be informed that if you are riding with the ventilations closed or using the Wind Shutter, may cause the Pinlock® Original Insert Lens to become fogged.
- Please replace Pinlock® Original Insert Lens if the anti-fog performance decreases and/or being scratched.
- Silicon seal may come into view depending on the riding position.

7 Remove/Replace Cheek pads

How to remove the cheek pad:

- ① First, undo the 2 snaps on the back side of the cheek pad.
- ② Pull a cheek pad by holding the centre of the pad as shown in Fig.2.
- ③ Follow the same steps on the other side.

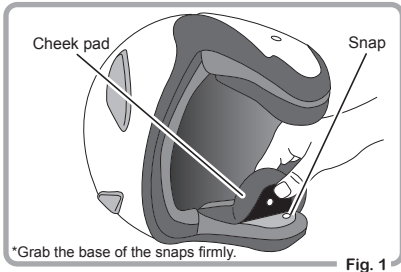

Fig. 1

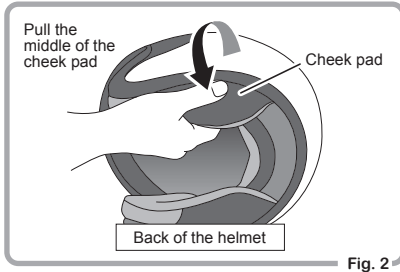

Fig. 2

! CAUTION

Be sure to grip the base of snaps when removing the cheek pad.
Otherwise, the parts of snaps may be damaged.

How to replace the cheek pad:

- ① Insert the rear Joint A in-between the shell and the liner.
- ② Hook the Joint B on the joint hook as shown in Fig.3.
- ③ Fasten the 2 snaps to complete attaching the pads. Follow the same steps on the other side as shown in Fig.4.

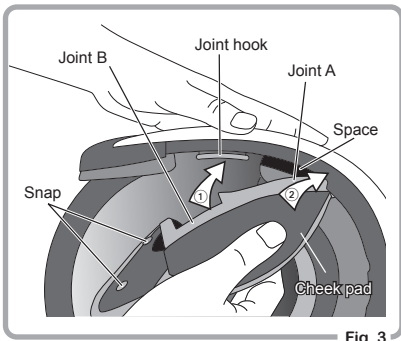

Fig. 3

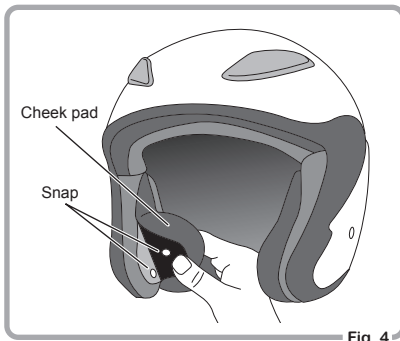

Fig. 4

! CAUTION

Be sure that the cheek pads are attached on the helmet securely before riding. It is hazardous to use this helmet without cheek pads or attaching the cheek pads improperly.

NOTE Exchangeable Inner Pad, Cheek Pads and Chinstrap covers

AVAND-II interiors are exchangeable as shown in the table below. Fine fitting can be achieved by changing only cheek pads etc.

■AVAND-II Inner pad

	Shell size	Pad size (Thickness)	Exchangeable	Included in package
	S	XS (15mm)	Interchangeable between the sizes of XS and S	Inner pad × 1pce
		S (12mm)		
	L	M (12mm)	Interchangeable between the sizes of M and L	Inner pad × 1pce
		L (9mm)		
	XL	XL (9mm)	XL size only	Inner pad × 1pce

■AVAND-II Cheek pads

	Shell size	Pad size (Thickness)	Exchangeable	Included in package
	S	XS (33mm)	Exchangeable among all sizes	Cheek Pad ×1 set (Right and Left)
		S (29mm)		
	L	M (24mm)		
		L (20mm)		
	XL	XL (16mm)		

■AVAND-II Chinstrap cover

Helmet size	Exchangeable	Included in package
XS•S	Between XS, S	Chinstrap cover (R/L) ×1set
M•L•XL	Between M, L, XL	Chinstrap cover (R/L) ×1set

8 Remove/Replace Inner Pad

How to remove the inner pad:

- ① Hold the helmet as shown in Fig.1 and then remove the interlining at the temple area on the right and left, individually.
- ② Remove the interlining at the centre as shown in Fig.2.
- ③ Unfasten the 3 snaps at the rear to remove the inner pad as shown in Fig.2.

⚠ CAUTION

Do not pull the interlining and snaps by force when removing the inner pad. Otherwise, the fabrics of those pads may be damaged.

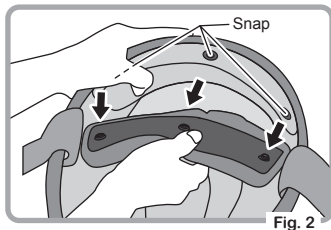
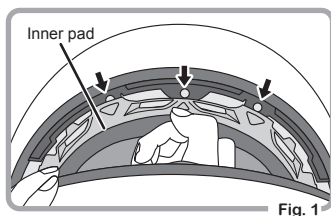

How to attach the inner pad:

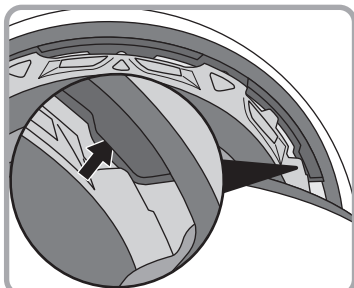

Fig. 1

- ① Insert the interlining at the temple areas as shown in Fig. 1.

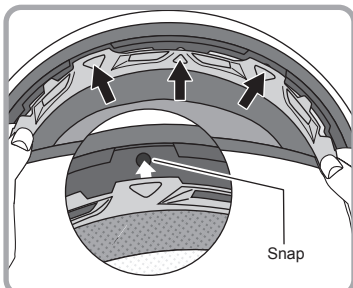

Fig. 2

- ② Insert the 3 snaps on the front as shown in Fig. 2.

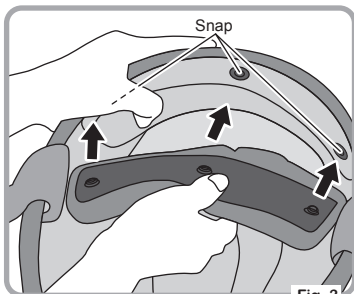

Fig. 3

- ③ Fasten 3 snaps at the rear to attach the inner pad completely.

! CAUTION

- If the inner pad is not securely installed, the helmet may be unstable while riding, thereby causing a great risk. Fasten the snaps properly.
- It is also important to attach the pads properly to wear your helmet comfortably.

IMPORTANT Cleaning of Inner Pad, Cheek Pads and Chinstrap Covers

! CAUTION

- The interiors of this helmet are washable by a washing machine. Put each pad in a washing net and wash them separately.
- Use detergent in cold water or warm water for cleaning. Never use hot water, chemical detergents, and organic solvents for cleaning the pads. The use of these agents may degrade the quality and damage the pads.
- Even commercially-available detergent may cause a little discolouration of the pad depending on the type of detergent. Thus, wash each pad separately as much as practical.
- If the pad is washed in a washing machine having a drying function in which the temperature is increased to 50°C or more, it may cause deterioration in quality and damage of the pads. Do not use such a device for cleaning of the pad.
- Drain a pad after washing and dry the pad in shade so that it is not exposed to direct sunlight. After making sure that it is dried enough, attach it on the helmet.
- The inner pad and the cheek pad are consumable items. Even under normal usage, the fabric material and inner foam may be worn and deteriorated depending on the frequency of usage. Please replace the pads with new ones as appropriate.

●AVAND-II Series Parts List and Table for Replacement

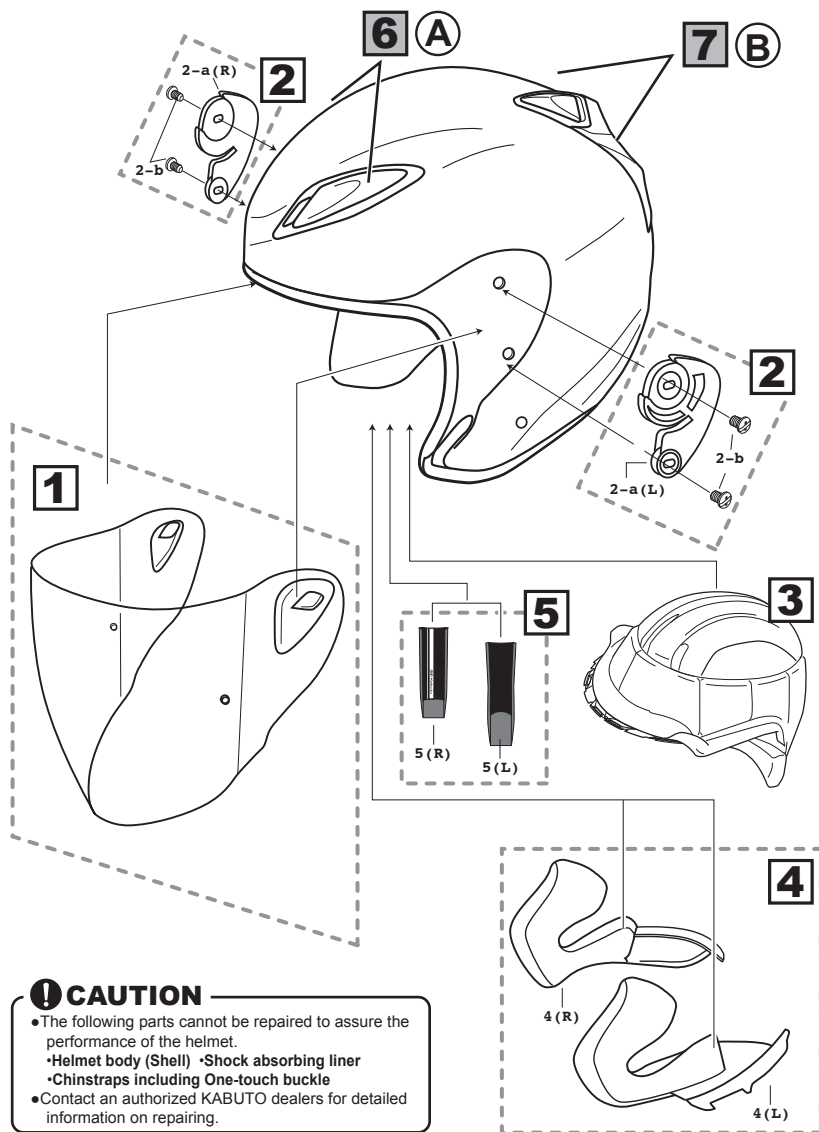

AVAND-II Series Parts for Replacement

	Parts	Contains
1	SAJ-P Shield	1:SAJ-P Shield (Standard:Clear) × 1pce
2	SAJ Shield Ratchets set	2-a:SAJ Shield Ratchet (R/L) × 1set
	SAJ Shield Ratchet Screws set	2-b: 6x6 screw ×4 pcs
3	AVAND-II Inner pad	2-b: 6x6 screw ×4 pcs
4	AVAND-II Inner pad	*See Page 18 (XS,S,M,L,XL) Inner pad x 1 pce
5	AVAND-II Cheek pads set	*See Page 18 (XS,S,M,L,XL) Cheek pads (R/L) x 1 set
6	AVAND-II Chinstrap covers set	*See Page 18 (XS,S,M,L,XL) Chinstrap covers (R/L) x 1 set
7	AVAND-II Head Ventilation	AVAND-II Head Ventilation (Each colour, right or left) x 1 pce
8	AVAND-II Rear Ventilation	For S, M, XL size shell (each colour, right or left) X 1 pce

- The parts listed above are available from an authorized KABUTO dealer.
- Parts with colour variations, specify your desired colour in your order.
- The materials and specifications are subject to change without prior notice for further improving the performance of the product.
- Check out our website for details about the parts.

AVAND-II Series Parts for Repair

- The following parts are repaired only at the authorized KABUTO dealers and are not available for direct sales to users in general.
- These parts are repaired at cost of the user except damage attributable to a defect in material and workmanship of KABUTO helmets.

	Part name & Repairs	Colour / Side	Remarks
A	Head Ventilation	Each colour/ Left side Each colour/ Right side	Purchasable
B	Rear Ventilation	Each colour/ Left side Each colour/ Right side	Purchasable

Contact for inquiries and request for repair:

Contact an authorized dealer of Kabuto helmets about the products and request for repair.

Request for repair

- Contact the authorized KABUTO dealer for request of repair.
- After inspected, there may be a case that your order of repairing cannot be accepted if it is judged that the safety performance of the helmet cannot be assured by repairing.

Parts that cannot be repaired

- The following parts cannot be repaired in terms of assuring the performance of the helmet.
- Helmet body (Shell)
- Shock absorbing liner
- Chinstraps including One-touch buckle (Main body, chin area)
- *Contact authorized KABUTO dealers for detailed information about repair and others.



OGK KABUTO

Kabuto Global Site : www.ogkkabuto.com